

REMOVAL AND INSTALLATION

Mode Door Actuator — Panel Door

1. Remove the instrument panel. For additional information, refer to Section 501-01.
2. Remove the components in the order indicated in the following illustration and table.
3. To install, reverse the removal procedure.

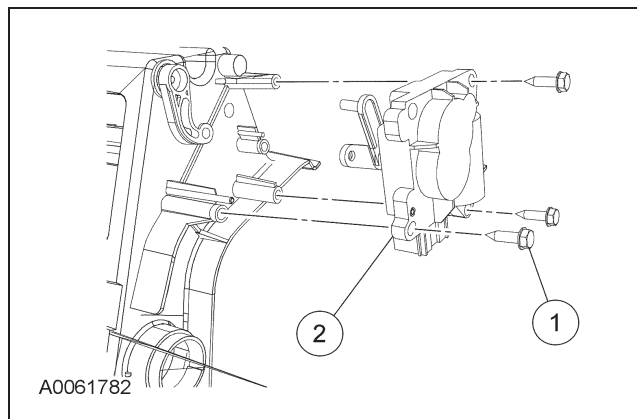

Item	Part Number	Description
1	W701696-S	Panel door actuator screw (3 req'd)
2	19E616	Panel door actuator